

# EMERGENCY OPERATIONS CENTRE (EOC)



## **EVACUATION ORDER – August 18, 2023, 1045 hrs**

### **Wildfire**

Pursuant to Section 13 (1) of the BC Emergency Program Act an **Evacuation Order** has been issued by the Regional District of Okanagan-Similkameen to protect the health, safety or welfare of a person or to limit damage to property due to: Wildfire.

Members of the RCMP and other agencies under the direction of RCMP will be expediting this action.

The **Evacuation ORDER** is in effect for the properties listed in Schedule 1 located in the following locations:

- Electoral Area “C” including Willowbrook, Madden Lake and Ripley Lake areas
- Electoral Area “G” properties on Grand Oro Road

Visit the RDOS EOC website for resource links and information updates:

<https://emergency.rdos.bc.ca/resources/>

*“Mark Woods”*

---

Mark Woods, EOC Director  
Regional District of Okanagan-Similkameen



*Link to Latest Updates*

# EMERGENCY OPERATIONS CENTRE (EOC)

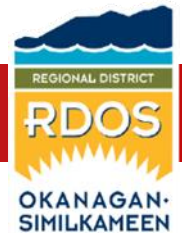

## Schedule 1 – List of Properties

### ELECTORAL AREA "C"

110 CARR CRES	1294 GREEN LAKE RD	487 JOHNSON CRES
128 CARR CRES	1300 GREEN LAKE RD	493 JOHNSON CRES
138 CARR CRES	1313 GREEN LAKE RD	499 JOHNSON CRES
156 CARR CRES	1316 GREEN LAKE RD	513 JOHNSON CRES
165 CARR CRES	1347 GREEN LAKE RD	525 JOHNSON CRES
181 CARR CRES	1369 GREEN LAKE RD	526 JOHNSON CRES
182 CARR CRES	1375 GREEN LAKE RD	533 JOHNSON CRES
183 CARR CRES	1398 GREEN LAKE RD	549 JOHNSON CRES
202 CARR CRES	580 GREEN LAKE RD	552 JOHNSON CRES
212 CARR CRES	590 GREEN LAKE RD	559 JOHNSON CRES
222 CARR CRES	594 GREEN LAKE RD	573 JOHNSON CRES
227 CARR CRES	638 GREEN LAKE RD	580 JOHNSON CRES
232 CARR CRES	647 GREEN LAKE RD	589 JOHNSON CRES
254 CARR CRES	675 GREEN LAKE RD	602 JOHNSON CRES
272 CARR CRES	676 GREEN LAKE RD	607 JOHNSON CRES
292 CARR CRES	698 GREEN LAKE RD	619 JOHNSON CRES
289 GOLDTAU RD	701 GREEN LAKE RD	629 JOHNSON CRES
294 GOLDTAU RD	734 GREEN LAKE RD	633 JOHNSON CRES
299 GOLDTAU RD	739 GREEN LAKE RD	643 JOHNSON CRES
1017 GREEN LAKE RD	741 GREEN LAKE RD	652 JOHNSON CRES
1043 GREEN LAKE RD	775 GREEN LAKE RD	657 JOHNSON CRES
1078 GREEN LAKE RD	792 GREEN LAKE RD	678 JOHNSON CRES
1082 GREEN LAKE RD	804 GREEN LAKE RD	698 JOHNSON CRES
1093 GREEN LAKE RD	805 GREEN LAKE RD	261 JONES WAY RD
1094 GREEN LAKE RD	815 GREEN LAKE RD	297 JONES WAY RD
1140 GREEN LAKE RD	871 GREEN LAKE RD	300 JONES WAY RD
1183 GREEN LAKE RD	951 GREEN LAKE RD	350 JONES WAY RD
1184 GREEN LAKE RD	409 JOHNSON CRES	351 JONES WAY RD
1198 GREEN LAKE RD	443 JOHNSON CRES	382 JONES WAY RD
1199 GREEN LAKE RD	458 JOHNSON CRES	130 LILLIAN RD
1221 GREEN LAKE RD	459 JOHNSON CRES	170 LILLIAN RD
1224 GREEN LAKE RD	465 JOHNSON CRES	3226 MEYERS RD
1235 GREEN LAKE RD	470 JOHNSON CRES	3264 MEYERS RD
1236 GREEN LAKE RD	471 JOHNSON CRES	118 OROFINO CREEK RD
1248 GREEN LAKE RD	478 JOHNSON CRES	143 OROFINO CREEK RD
1264 GREEN LAKE RD	479 JOHNSON CRES	450 OROFINO CREEK RD
1265 GREEN LAKE RD	486 JOHNSON CRES	455 OROFINO CREEK RD

Follow RDOS on [Facebook](#) [Twitter](#) [YouTube](#) [LinkedIn](#)

Website: [emergency.rdos.bc.ca](http://emergency.rdos.bc.ca) Email: [eocinfo@rdos.bc.ca](mailto:eocinfo@rdos.bc.ca) Phone: 250-490-4225

[Voyent Alert!](#) notifications – sign up for routine and emergency notifications

Issued by Director of RDOS EOC

# EMERGENCY OPERATIONS CENTRE (EOC)

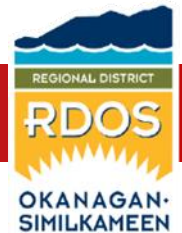

197 PAMPAS GRASS WAY	2737 WILLOWBROOK RD	3395 WILLOWBROOK RD
199 PAMPAS GRASS WAY	2807 WILLOWBROOK RD	3400 WILLOWBROOK RD
2467 WILLOWBROOK RD	2839 WILLOWBROOK RD	3413 WILLOWBROOK RD
2469 WILLOWBROOK RD	2850 WILLOWBROOK RD	3426 WILLOWBROOK RD
2545 WILLOWBROOK RD	2867 WILLOWBROOK RD	3566 WILLOWBROOK RD
2581 WILLOWBROOK RD	2895 WILLOWBROOK RD	3639 WILLOWBROOK RD
2591 WILLOWBROOK RD	3200 WILLOWBROOK RD	3749 WILLOWBROOK RD
2609 WILLOWBROOK RD	3274 WILLOWBROOK RD	3775 WILLOWBROOK RD
2681 WILLOWBROOK RD	3348 WILLOWBROOK RD	3801 WILLOWBROOK RD

BLOCK B, DISTRICT LOT 3100, SIMILKAMEEN DIV OF YALE LAND DISTRICT, THAT PT AS SHOWN ON MAP ATTACHED TO LICENCE 340265 ISSUED FOR PLACEMENT & USE OF WATER STORAGE TANKS FOR FIRE PROTECTION PURPOSES

DISTRICT LOT 106, SIMILKAMEEN DIV OF YALE LAND DISTRICT, EXCEPT PLAN 34744 H14405

DISTRICT LOT 2073S, SIMILKAMEEN DIV OF YALE LAND DISTRICT

DISTRICT LOT 21, SIMILKAMEEN DIV OF YALE LAND DISTRICT

DISTRICT LOT 22, SIMILKAMEEN DIV OF YALE LAND DISTRICT

DISTRICT LOT 2251S, SIMILKAMEEN DIV OF YALE LAND DISTRICT, PORTION W/I D L 3981S, SURFACE SCOTCHMAN M C

DISTRICT LOT 2251S, SIMILKAMEEN DIV OF YALE LAND DISTRICT, PORTION W/I D L 3982S, SURFACE STANDARD M C

DISTRICT LOT 2252S, SIMILKAMEEN DIV OF YALE LAND DISTRICT, PORTION W/I D L 3981S, SURFACE STANDARD M C

DISTRICT LOT 2252S, SIMILKAMEEN DIV OF YALE LAND DISTRICT, PORTION W/I D L 3982S

DISTRICT LOT 27, SIMILKAMEEN DIV OF YALE LAND DISTRICT, PORTION EX BLK A, EXCEPT PLAN 40005, FOR PL 37409 - C/REF 01132.501

DISTRICT LOT 3097, SIMILKAMEEN DIV OF YALE LAND DISTRICT

DISTRICT LOT 3953S, SIMILKAMEEN DIV OF YALE LAND DISTRICT, PORTION EX W 5 CHN OF S 5 CH

Follow RDOS on [Facebook](#) [Twitter](#) [YouTube](#) [Linkedin](#)

Website: [emergency.rdos.bc.ca](http://emergency.rdos.bc.ca) Email: [eocinfo@rdos.bc.ca](mailto:eocinfo@rdos.bc.ca) Phone: 250-490-4225

[Voyent Alert!](#) notifications – sign up for routine and emergency notifications

Issued by Director of RDOS EOC

# EMERGENCY OPERATIONS CENTRE (EOC)



DISTRICT LOT 520S, SIMILKAMEEN DIV OF YALE LAND DISTRICT, LETTER AUTHORIZATION NO 302682 FOR RD ACCESS

DISTRICT LOT 528S, SIMILKAMEEN DIV OF YALE LAND DISTRICT

DISTRICT LOT 714S, SIMILKAMEEN DIV OF YALE LAND DISTRICT, PORTION N 55 CHN OIC 1501/61, FOR PL 37409 C/REF 04009.101

LOT 1, PLAN KAP60687, DISTRICT LOT 28, SIMILKAMEEN DIV OF YALE LAND DISTRICT

LOT 3, PLAN KAP1435, DISTRICT LOT 28, SIMILKAMEEN DIV OF YALE LAND DISTRICT

LOT 4, PLAN KAP1435, DISTRICT LOT 28, SIMILKAMEEN DIV OF YALE LAND DISTRICT

LOT 4, PLAN KAP21824, DISTRICT LOT 3098, SIMILKAMEEN DIV OF YALE LAND DISTRICT

PLAN KAP15882B, DISTRICT LOT 3101, SIMILKAMEEN DIV OF YALE LAND DISTRICT, EXCEPT PLAN H18011

SECTION 23, TOWNSHIP 53, SIMILKAMEEN DIV OF YALE LAND DISTRICT, PORTION N 1/2 OF NW 1/4, ALSO KNOWN AS D L 1006 LEASE 42901-6

## **ELECTORAL AREA "G"**

DISTRICT LOT 1448, SIMILKAMEEN DIV OF YALE LAND DISTRICT, SURFACE RIGHTS ORO FINO MC

DISTRICT LOT 1449, SIMILKAMEEN DIV OF YALE LAND DISTRICT, SURFACE RIGHTS INDEPENDENCE MC

**YOU MUST LEAVE THE AREA IMMEDIATELY**

# EMERGENCY OPERATIONS CENTRE (EOC)



## Schedule 2 - Evacuation Order Maps

### ELECTORAL AREA "C"

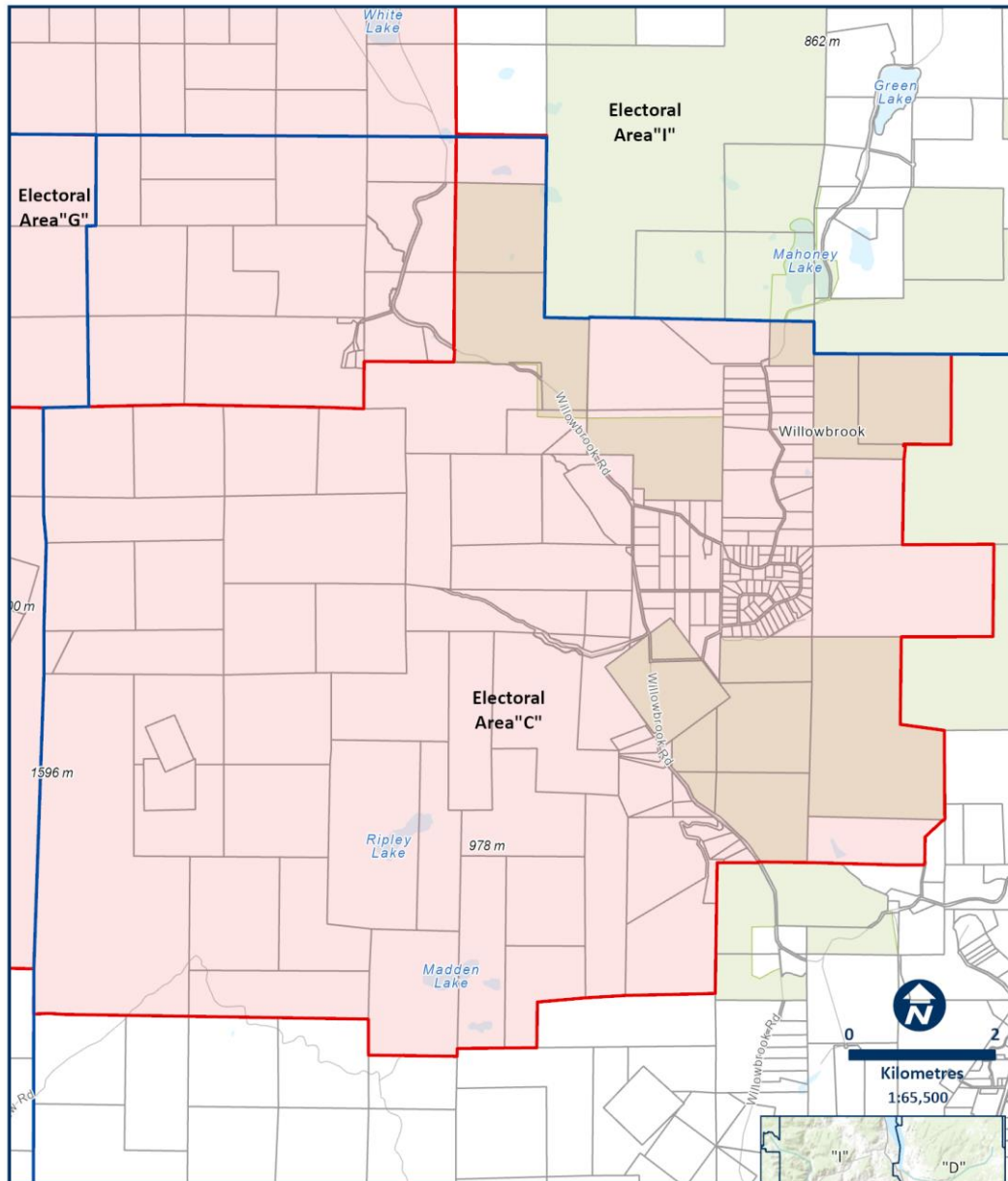

Regional District of Okanagan - Similkameen  
**Evacuation Order - Upper Park Rill Creek wildfire**  
Date Effective: 20230818  
Willowbrook to Taylor Lake and Madden Lake

- Order
- Alert
- Rescind

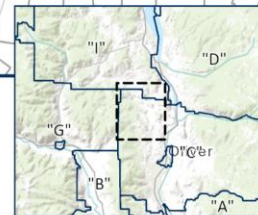

Follow RDOS on Facebook Twitter YouTube LinkedIn  
Website: [emergency.rdos.bc.ca](http://emergency.rdos.bc.ca) Email: [eocinfo@rdos.bc.ca](mailto:eocinfo@rdos.bc.ca) Phone: 250-490-4225  
[Voyent Alert!](#) notifications – sign up for routine and emergency notifications  
Issued by Director of RDOS EOC

# EMERGENCY OPERATIONS CENTRE (EOC)

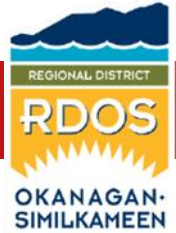

## ELECTORAL AREA "G"

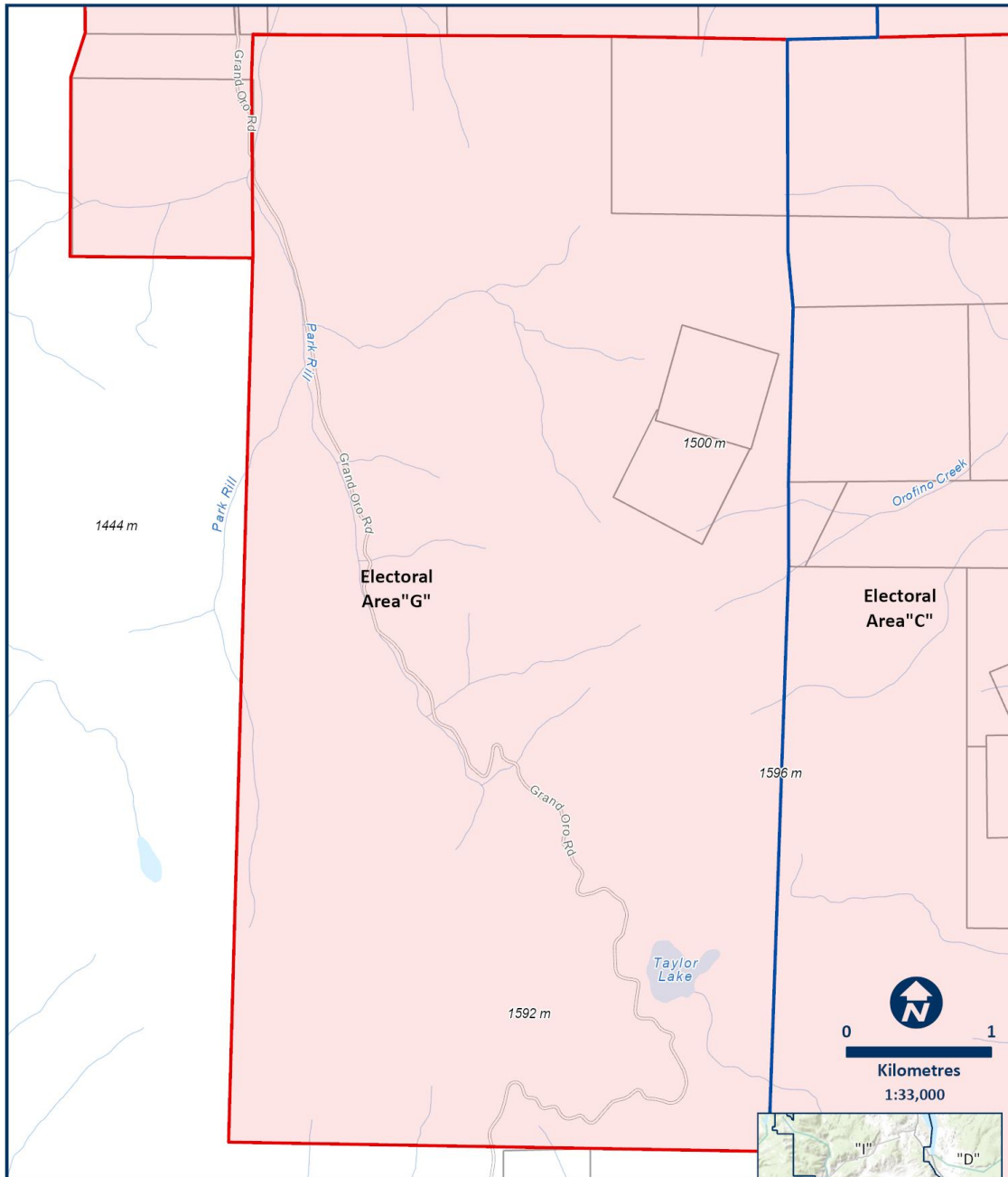

Regional District of Okanagan - Similkameen  
**Evacuation Order - Upper Park Rill Creek wildfire**  
Date Effective: 20230818  
Area "G" Grand Oro Road Backcountry

- Order
- Alert
- Rescind

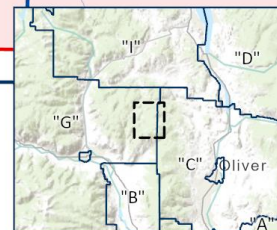

Follow RDOS on [Facebook](#) [Twitter](#) [YouTube](#) [Linkedin](#)  
Website: [emergency.rdos.bc.ca](http://emergency.rdos.bc.ca) Email: [eocinfo@rdos.bc.ca](mailto:eocinfo@rdos.bc.ca) Phone: 250-490-4225  
**Voyent Alert!** notifications – sign up for routine and emergency notifications  
Issued by Director of RDOS EOC

# EMERGENCY OPERATIONS CENTRE (EOC)



## WHAT YOU SHOULD DO:

- You must leave the area **immediately**.
- Follow directions of emergency responders and travel designated or safest route available.
- Register online at [ess.gov.bc.ca](http://ess.gov.bc.ca)
- Go to the **ESS Reception Centre at 199 Ellis Street, Penticton** –if you require immediate assistance
  - Due to a shortage of commercial/hotel accommodation, consider making arrangements to stay with family or friends if possible.
  - Take pets with you if you can.
  - **For ESS Support by phone, call 250-486-1890**
- If you need transportation assistance, call **RDOS EOC: 250-490-4225**
- Gather your family; if you have room, take a neighbor or someone needing transportation.
  - Do not use more vehicles than you have to.
- **Do not turn off your natural gas. FortisBC will turn off natural gas service as needed.**
- Store your Firearms in accordance with Section 118 of the Firearms Act.
- Close all windows and doors.
- Close gates (latch) **but do not lock**.



*Link to Latest Updates*

## WHAT TO TAKE:

- Critical items *only if they are immediately available*:
  - government-issued ID
  - medications
  - eyeglasses
  - valuable papers (e.g. insurance, credit, and mortgage information)
  - immediate care needs for dependents
- Pets in pet kennels or on leash.
  - **Pet owners and hobby farmers** with concerns for their animals *may* contact:
    - **Animal Emergency Response Team (ALERT): 250-809-7152**
  - **Commercial Farmers** who require assistance *may* contact:
    - **RDOS EOC: 250-490-4225**

## YOU MUST LEAVE THE AREA IMMEDIATELY

**At the Reception Centre** – Emergency Support Service (ESS) volunteers are able to assist you to meet your basic needs by providing service for up to 72 hours. This may include coordinating food, clothing, lodging and transportation.

- If you are not able to attend the reception center and require support, call **250-486-1890**.
- An ESS volunteer will return your call.

ESS is a safety net program available when alternatives such as family, friends, and insurance cannot be accessed. ESS is not offered if insurance is accessible. In situations where insurance exists, but cannot be immediately accessed, interim support may be provided.

Follow RDOS on [Facebook](#) [Twitter](#) [YouTube](#) [LinkedIn](#)

Website: [emergency.rdos.bc.ca](http://emergency.rdos.bc.ca) Email: [eocinfo@rdos.bc.ca](mailto:eocinfo@rdos.bc.ca) Phone: 250-490-4225

[Voyent Alert!](#) notifications – sign up for routine and emergency notifications

Issued by Director of RDOS EOC