

# FAULDER WATER 2021

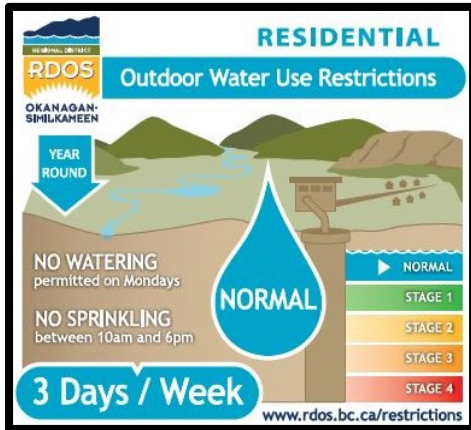



## RESIDENTIAL WATERING RESTRICTIONS FOR SYSTEM USERS

### STAGE NORMAL

The Regional District of Okanagan-Similkameen reminds Faulder water system customers that **Stage Normal** watering restrictions are in effect year-round or until situations change.

**Shaded Grey** properties on map → **Tuesday, Thursday and Saturday**

**Non-shaded** properties on map → **Wednesday, Friday, and Sunday**

Watering Established Lawns, Shrubs/Flowers	Newly Planted Sod, Trees or Flowering Shrubs	Outdoor Cleaning	Topping Up/ refilling Pools, Hot Tubs, Ponds or Water Features
<u>Manual Sprinklers:</u> <b>3 days per week</b> <b>6:00 AM to 10:00 AM</b> <b>6:00 PM to 10:00 PM</b> <b>On your watering day</b> 	<u>Seeded Lawns or Turf:</u> Any day at any time using any method for the first 49 days after installation of seeded lawns.	<u>Driveways, Sidewalks, Patios and Decks:</u> Any day, using any method provided it does not result in <b>*Excess Water Use</b> <i>It is suggested to use a broom, or hose with spring loaded shut off nozzle</i>	<u>Maximum Volume:</u> 4,000 litres <u>No Time Restrictions:</u> Any day, any time <b>Note:</b> for volumes above 40,000 litres, 24-hours notice must be provided to the RDOS 
<u>Automated Irrigation Systems:</u> <b>12:01 AM to 6:00 AM</b> <b>On your watering day</b>	<u>Trees and Flowering Shrubs:</u> Any day at any time using any method for 21 days after planting of new trees and flowering shrubs. Stage 1 restrictions are required after 21 days	<b>*Excess water use</b> is defined as applying more water than is required to provide a service, produce a product, or complete a task	
<b>Hand watering</b> of flower and vegetable gardens is allowed daily; drip or handheld	<b>Stage 'Normal'</b> represents normal conditions for the local area and your water system. <b>Water Restriction Stages</b> are important to conserve water, minimize pumping costs and maintain adequate volumes (flow) for fighting fire.		



## Map: Faulder Watering Schedule

### ***Faulder Watering Schedule***

-  Wednesday, Friday, Sunday
-  Tuesday, Thursday, Saturday

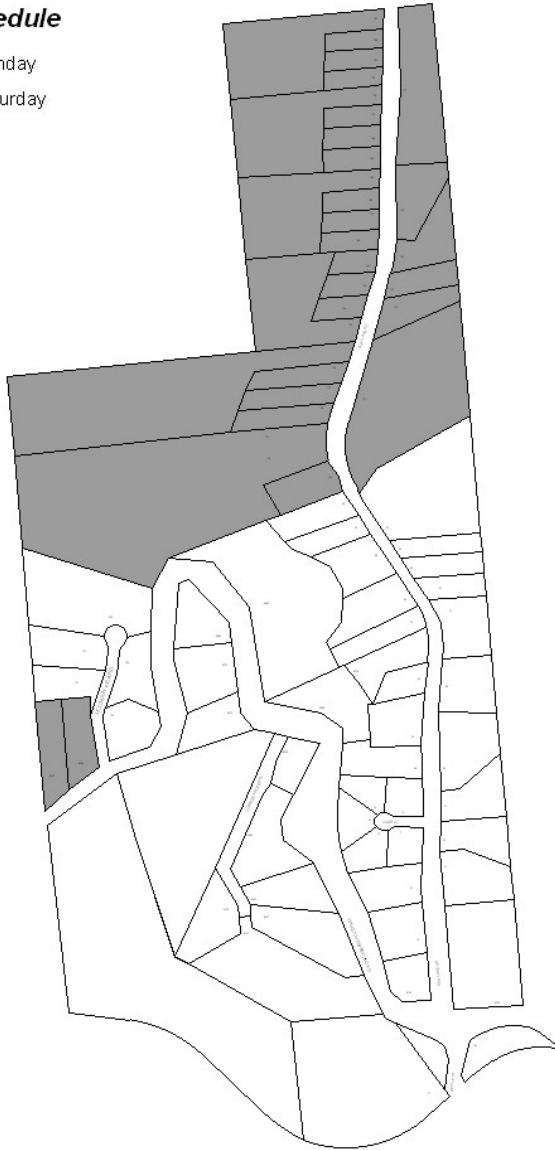

# Helpful Reminders Enclosed

The RDOS has created two, helpful items to make it easy to follow residential sprinkling regulations

The 4" x 6" magnet can be placed on a fridge or any metal surface like a filing cabinet or even some exterior doors. Place the magnet where it will cue occupants to adhere to sprinkling regulations and if applicable, to insure automatic timers are set correctly.

**RESIDENTIAL Outdoor Water Use Restrictions**

RDOS  
OKANAGAN-SIMILKAMEEN

YEAR ROUND

NO WATERING permitted on Mondays  
NO SPRINKLING between 10am and 6pm

**3 Days / Week**

**MAKE WATER WORK for you!**

- Water plants not pavement
- Low water plants save you money
- Wash the car on the lawn

[www.rdos.bc.ca/restrictions](http://www.rdos.bc.ca/restrictions)

**For more info, call Public Works 250.492.0237**

**WATER USE REGULATIONS in all RDOS water systems**  
year round unless notified

Hand held garden hose up to Stage 2 any day, anytime

**NO watering on Mondays**

**STAGE NORMAL WATERING SCHEDULE:**

	TUE	THU	SAT
<b>EVEN</b> numbered civic address	6-10am & 6-10pm		

**AUTOMATIC residential irrigation:**  
12:01am to 6am on your watering day

	WED	FRI	SUN
<b>ODD</b> numbered civic address	6-10am & 6-10pm		

The 2" x 3" plastic reminder is for the most used outdoor faucet, where the hose attaches – known as a hose-bib. The envelope will contain a zap-strap to help secure it to the shaft of the faucet.

**RESIDENTIAL Outdoor Water Use Restrictions**

RDOS  
OKANAGAN-SIMILKAMEEN

YEAR ROUND

NO WATERING permitted on Mondays  
NO SPRINKLING between 10am and 6pm

**3 Days / Week**

**MAKE WATER WORK for you!**

*See reverse for sprinkling regulations*

- Water plants not pavement
- Low water plants save you money
- Wash the car on the lawn

[www.rdos.bc.ca/restrictions](http://www.rdos.bc.ca/restrictions)



For a complete list of all Watering Restriction Stages, visit: <https://www.rdos.bc.ca/public-works/utilities/water-systems/faulder/>, look for **Water System Updates** and click on **New Water Regulation Bylaw**.  
**For after-hours** water-related emergencies, contact Regional Dispatch at 250.490.4141.

**Regional District of Okanagan-Similkameen**

**Public Works Department**

**Feb 2021**